

## N Making the chin rest.

73 Attach the back sides together.



74 Attach the back sides together.



75 Attach the back sides together.

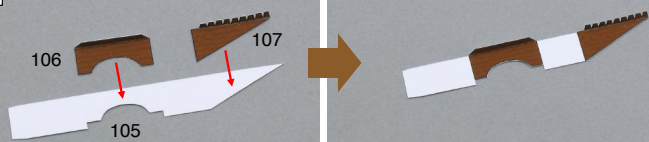

76



77

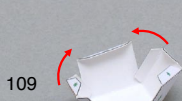

78

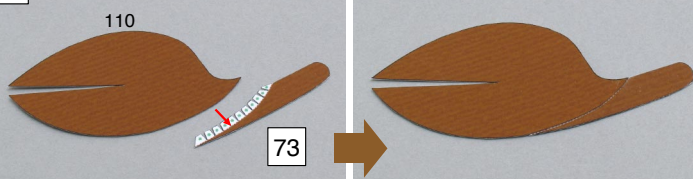

79 As shown here, attach it so that its center becomes curved.

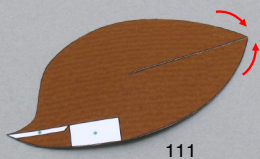

80

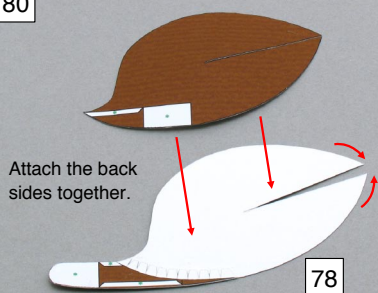

81

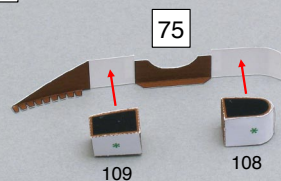

82

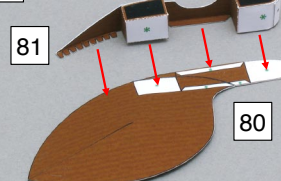

83

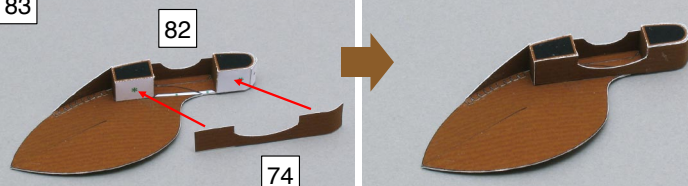

84

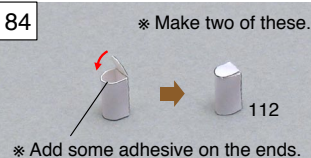

85

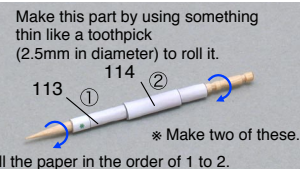

86

After attach the back sides together, cut out the orange parts.

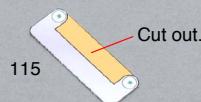

87

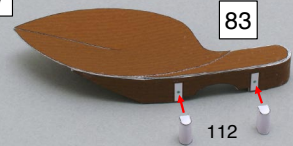

88

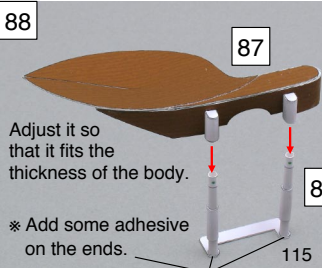

\* This is how the chin rest will appear when completed.

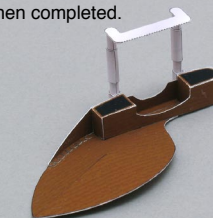

As shown here, attach the chin rest.

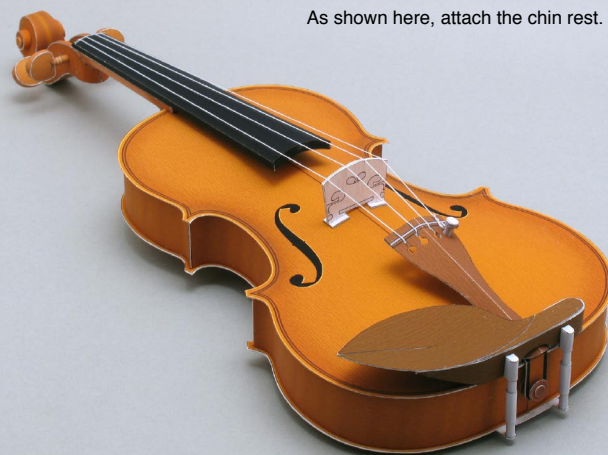



## ○ Making the bow.

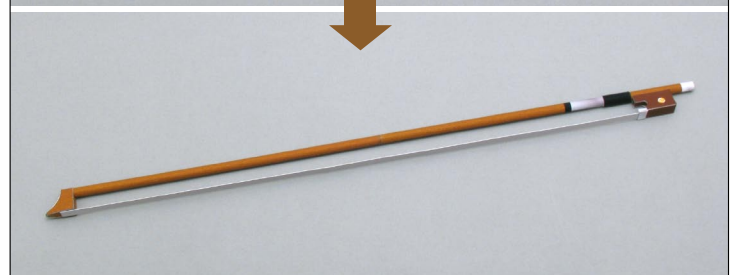
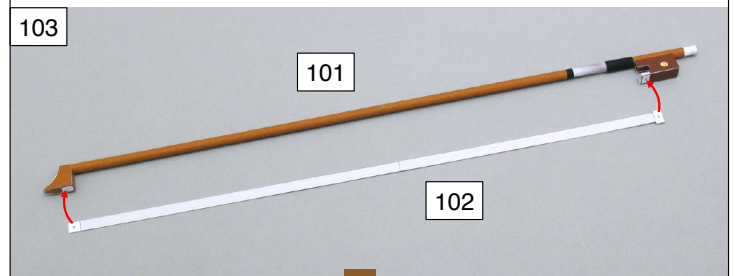
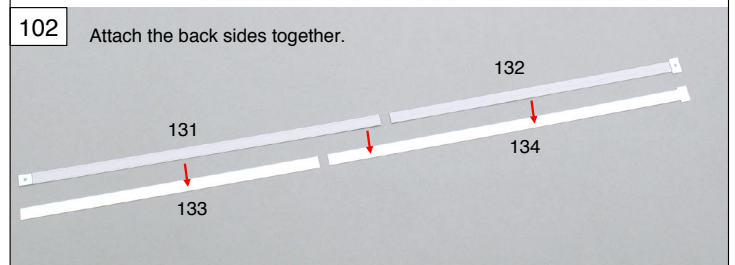
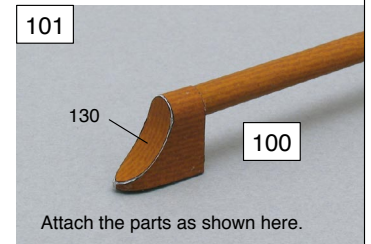
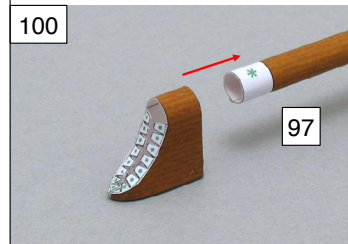
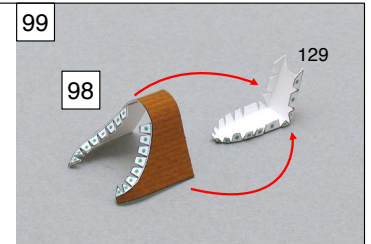
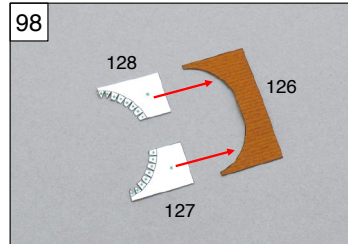
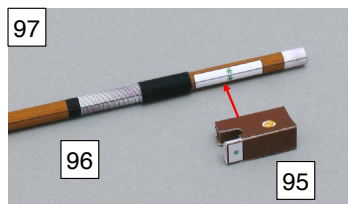
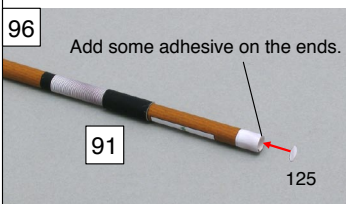
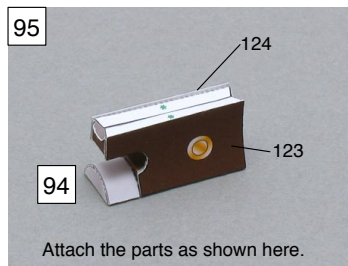
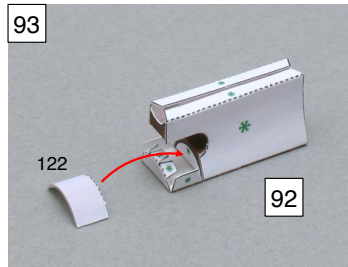
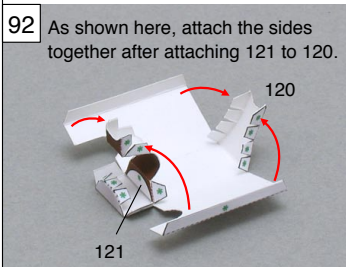
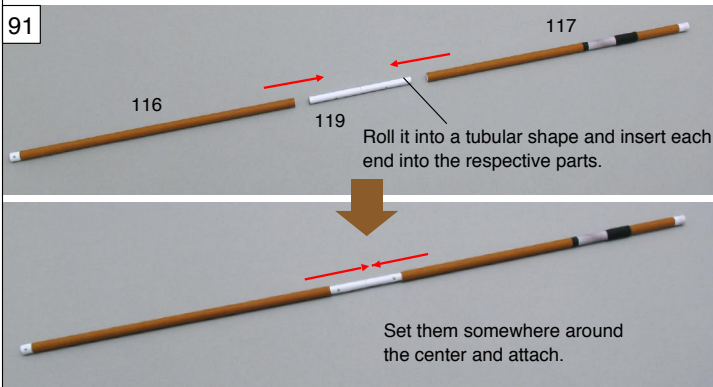
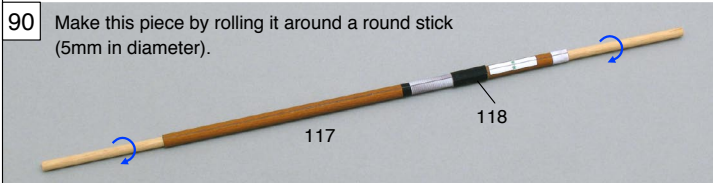
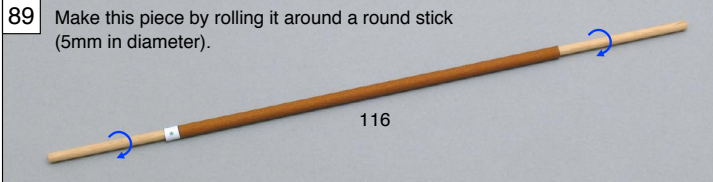

**P Making the violin's stand.**

